

# Measuring and Installation

## Measuring up, and calculating how many panels you will need:

### Walls:

Panels are normally fixed vertically i.e. from floor to ceiling.

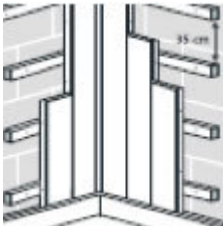

Panels are 2.7m in length - more than the average room height.

Panels may be fitted horizontally if the shape of the room makes this an easier option.

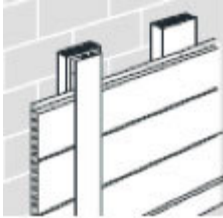

All of our panels come in packs that will cover a linear meter, i.e the panels are 250mm wide each and there are 4 panels in a pack; therefore a pack will cover a meter.

Panels are sold in packs and measurements should be rounded up to the nearest full pack. i.e. 4.5 packs - order 5 packs.

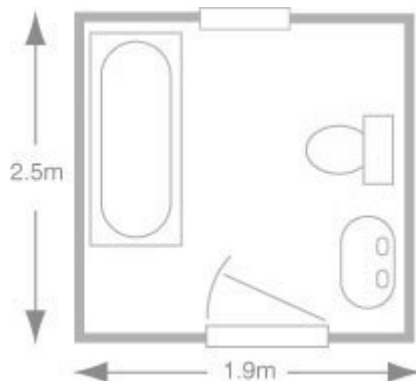

In simple terms, this room has walls adding to 8.8 m; therefore 9 packs are required.

Of course only the part above the door needs to be covered, saving the material at the door itself. In some cases this 'saved' material is enough to cover above and below the window. The same consideration can be given to bath or any other areas where a much less than a full length panels is required, but remember that you should make some allowance for cutting mistakes, and that materials needed should be rounded up to full packs regardless.

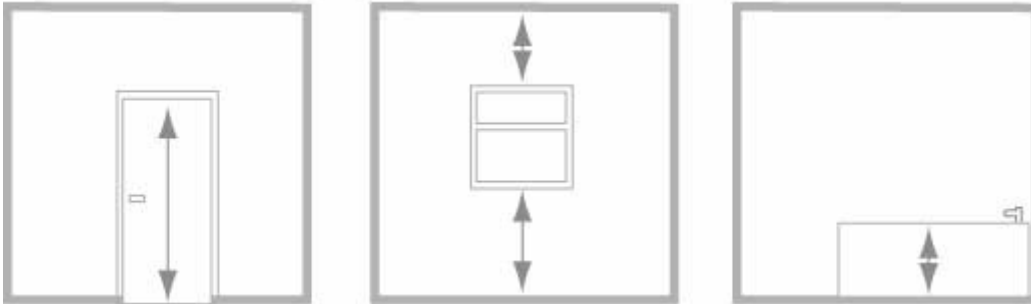

### Ceilings:

Ceiling panels can be run in either direction;

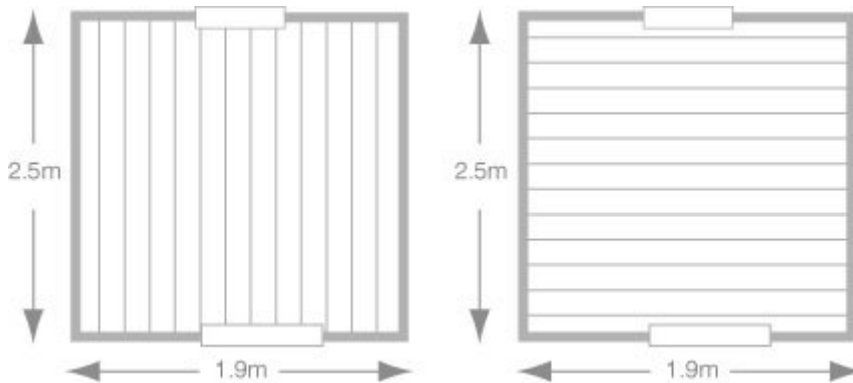

You should consider both directions as one way is likely to need less material than the other. In the case above 3 packs are required running one way and 2 packs the other.

Of course, you may have a preference as to which way you would like run the panels for visual effect.

## Installation Guide

This short guide will help you with the installation of your panelling to complete your project.

### Panel Fixing Methods

Our Decorative PVC panels are easily fixed to almost every surface including Brick, Breezeblock, Plaster, Wooden Battens, even over existing ceramic tiles. Depending on the type of wall or ceiling to be fixed you can choose just one or a combination of the four different types of fixing.

**Nailing:** apply nails evenly and level in the panel lip. Be careful not to hit the panel with the hammer. This method only applies when fixing the cladding to a wooden surface or battening. Make sure the battening is flat and level, packing out where necessary on uneven walls so that when applied the cladding does not develop curvature and follow the walls contours.



In cases of damp and uneven walls we recommend the use of treated timbers for battening. Ensure that you leave sufficient ventilation behind the cladding by providing air gap. Position battens between 40 to 60cm centres.

**Screw fix:** Apply screws through the panel lip as shown in the diagrams below. Screw fixing can be made to wooden battens. However breezeblock, brick or plasterboard will require the wall to be plugged before screwing. When the first plank is fixed in place the next conceals the previous fixing see diagram below.



**Stapling:** You can use stainless steel staples when fixing to plaster or wooden battens - this method is particularly suitable when using battens. Always make sure your battens are flat and level, packing them out where necessary on uneven walls, this will prevent the panels from developing a curvature following the wall contours.



**Gluing:** This is the method most preferred by many installers however you can only use adhesive when applied to a dry, even wall. The wall must be free of any greasy substances and dust. We recommend MS-polymer.



## Getting Started

### Walls

Always ensure that the first plank to be fixed is plumb (Fig 1) check with spirit level. Once the first panel is in position it is then a simple process of adding panels (Fig 2) fixing them in place by one of the methods explained above.

If fixing the panels to a curved wall a horizontal fix would be the best method (Fig 3)



Fig 1.

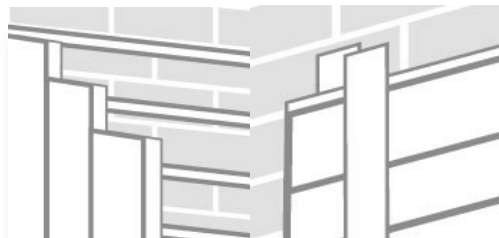

Fig 2.

Fig 3.

### Corners

**Corners can be formed in one of two ways:**

1: Use an internal/external angle corner trim

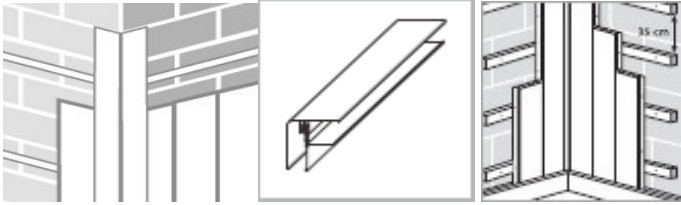

2: Through the design and flexibility of the panels they can be cut at the back this then allows them to be bent either internally or externally around a corner, care must be taken to bend the panels slowly until the desired angle is achieved. Do not bend past 90 degrees. During this fix the panel will have a tendency to spring back pressing the panel into the corner and fixing through the external lip will stop this.

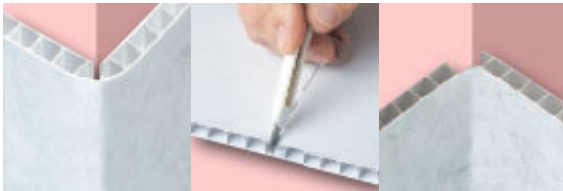

**The vast majority of installations may be completed with the following two parts:**

Corner trims may be used on internal or external corners and are available to colour co-ordinate with each of the panel designs.

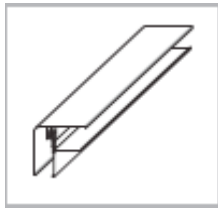

H trims can be used to join the panels end to end. J trims are designed to create starting/finishing of the installation and again are colour co-ordinated with the range of panels.

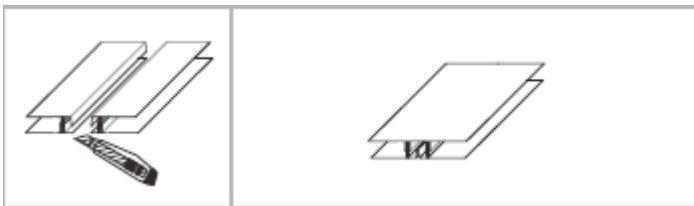

## Fixing

Where possible, all trims should be fitted to the wall and then slide the panels into position - in many cases the trims themselves do not need to be fixed directly to the wall as the panels will hold them in position, but as with the panels the trim may be glued, screwed, or stapled.

## Chrome Strips.

Chrome strips can be used to create a great a feature between panels to break up the wall/ceiling finish.

### Chrome Strip - leaves a raised profile.

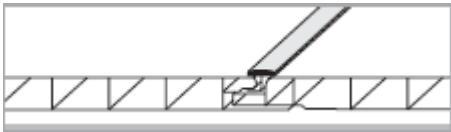

When fixing wall furnishings, mirrors, etc to the panels care must be taken not to over tighten the screws into the plugs as this will crush the panel. One easy way to avoid this is to sink the plug to the back of the pre-drilled hole, then cut the plug to length so it is level with the front surface of the plank this will stop the screw being over tightened.

The use of battens allows you to install cables for switches, plugs for power supply, phones sockets etc.

Do not apply the panels around heat radiating objects exceeding 60°C.  
Check the temperature around these objects before installation.

All decorative panels are UV resistant.